

brunner ::

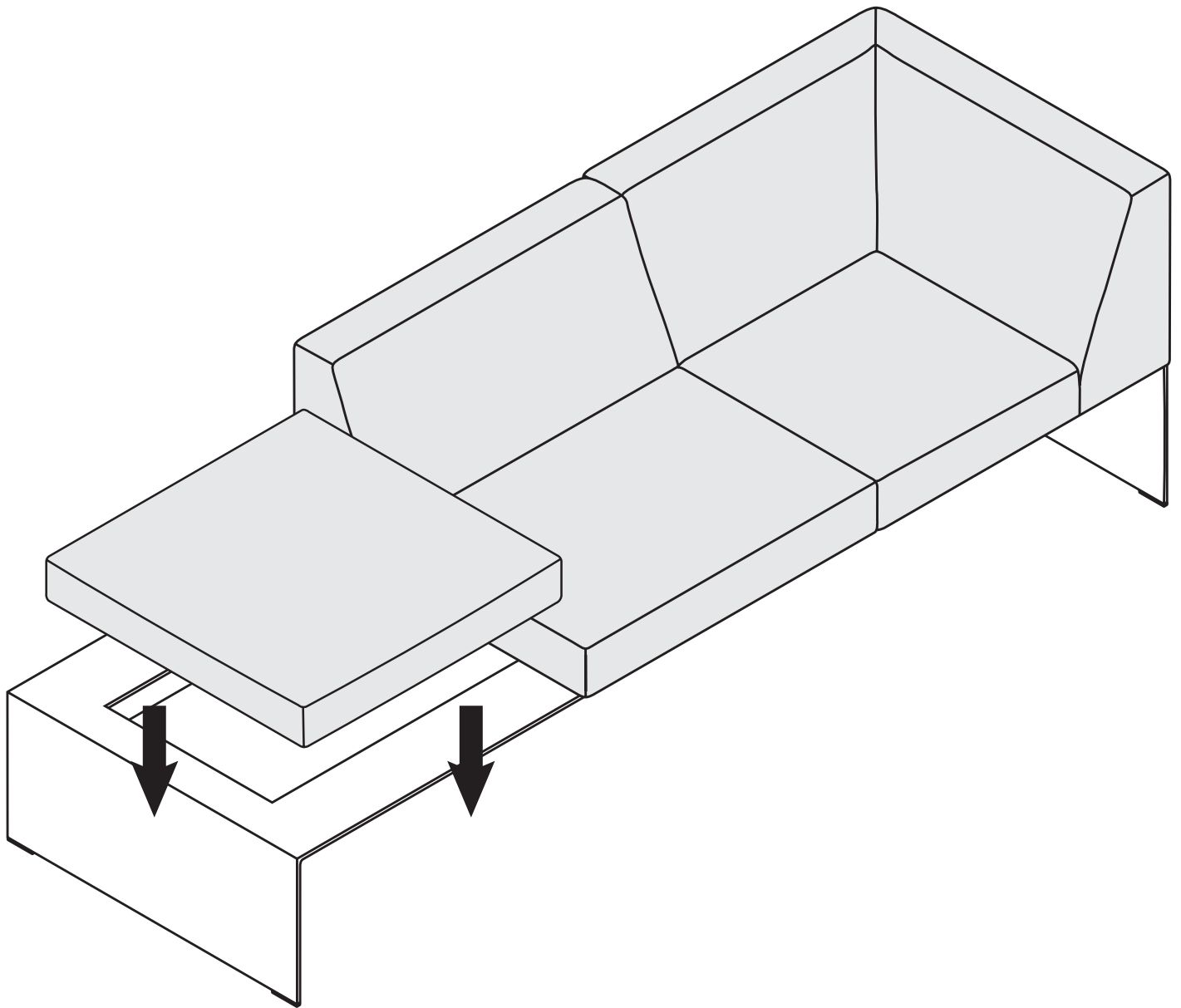

banc

Assembly instructions
Design: jehs+laub

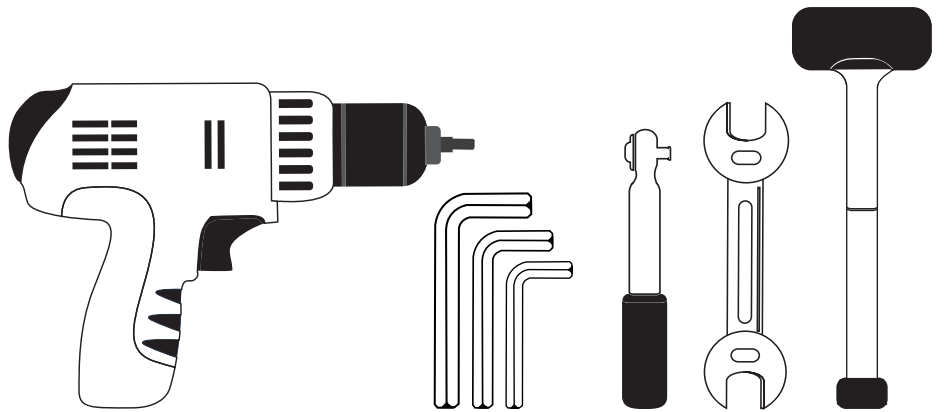

Thank you for buying a quality Brunner product from the banc series.

The modular lounge system is highly versatile and can be flexibly extended and reconfigured at any time thanks to a smart principle based on building blocks.

This allows you to completely reconfigure existing lounge elements into new landscapes at great speed and with great ease. After delivery the bases are first connected to one another and screwed tight. Several bases can also be combined.

The upholstery elements then simply have to be fitted to the bases with brackets. There is a suitable connector for every lounge landscape. The assembly instructions below show you all relevant components and will help you to assemble your banc lounge system with ease.

BANC ASSEMBLY INSTRUCTIONS

Contents

4 Elements of the modular lounge system

5 Configuration examples

6 Assembly of a lounge element

- 6 Fitting the gliders
- 7 Fitting the bases
- 8 Fitting the seat upholstery
- 9 Connecting the seat upholstery
- 10 Fitting a supporting plate
- 11 Fitting the cabin/Fitting the bases
- 12 Fitting the cabin seat upholstery
- 14 Connecting the cabin seat upholstery

15 Connecting several lounge elements

- 15 Linear connection of two lounge elements
- 16 Connection of two lounge elements back to back
- 17 Connection of two lounge elements across a corner

18 Adding the bar counter

20 Electrics and cabling

21 Additional information

- 21 General information about assembly
- 21 Assembly tool for the modular banc lounge system
- 21 Care instructions – powder-coated bases
- 21 Care instructions – cover materials and leather
- 22 Note
- 22 Imprint

ELEMENTS OF THE MODULAR LOUNGE SYSTEM

Table and upholstery elements

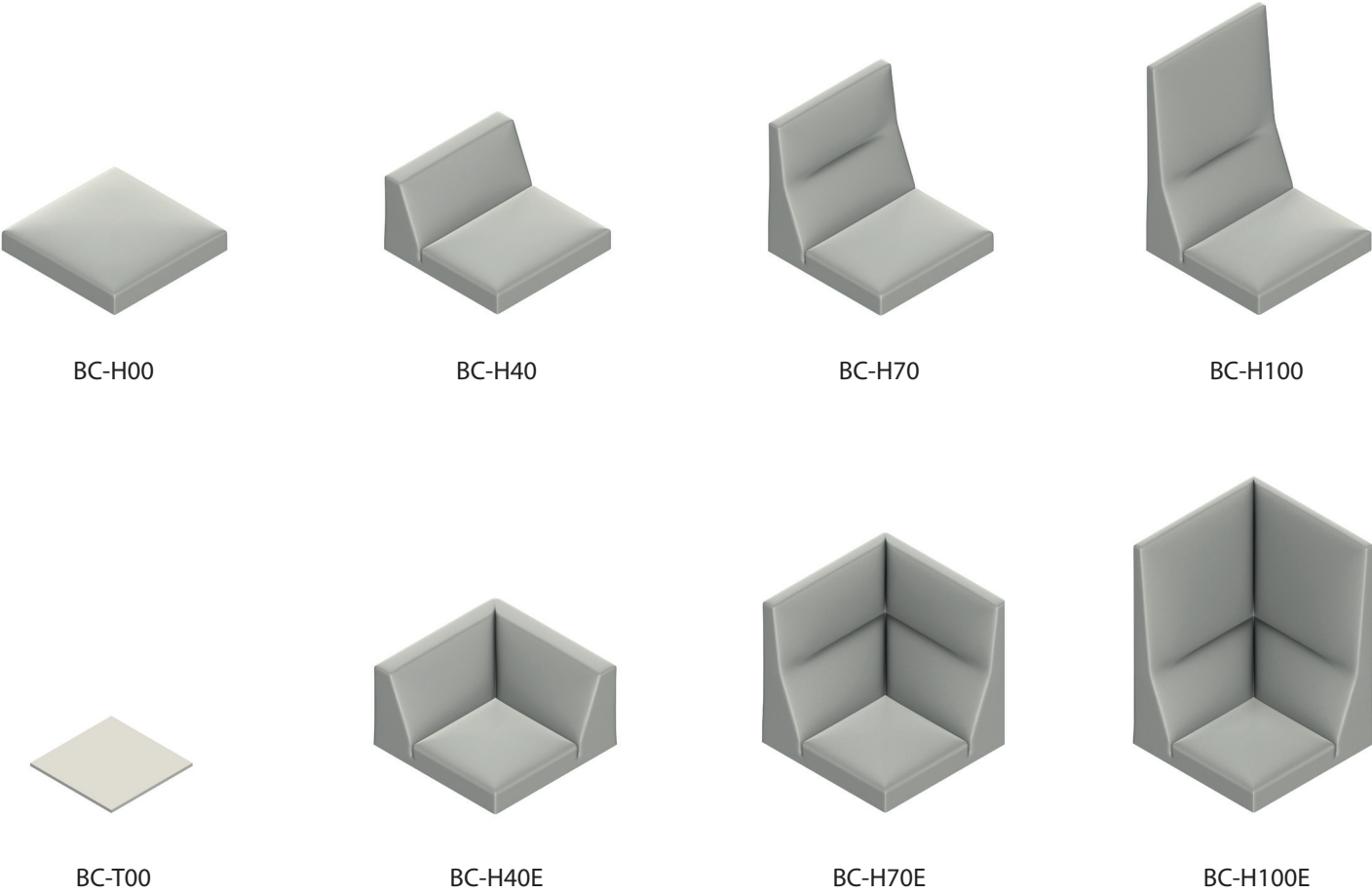

Bases

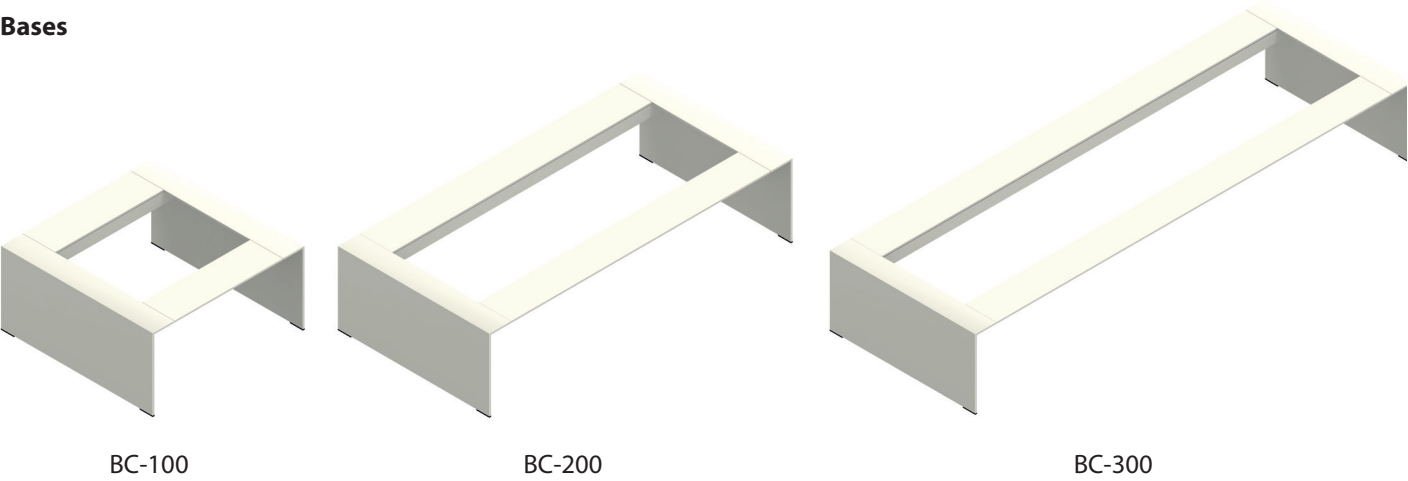

Configurations of the lounge elements

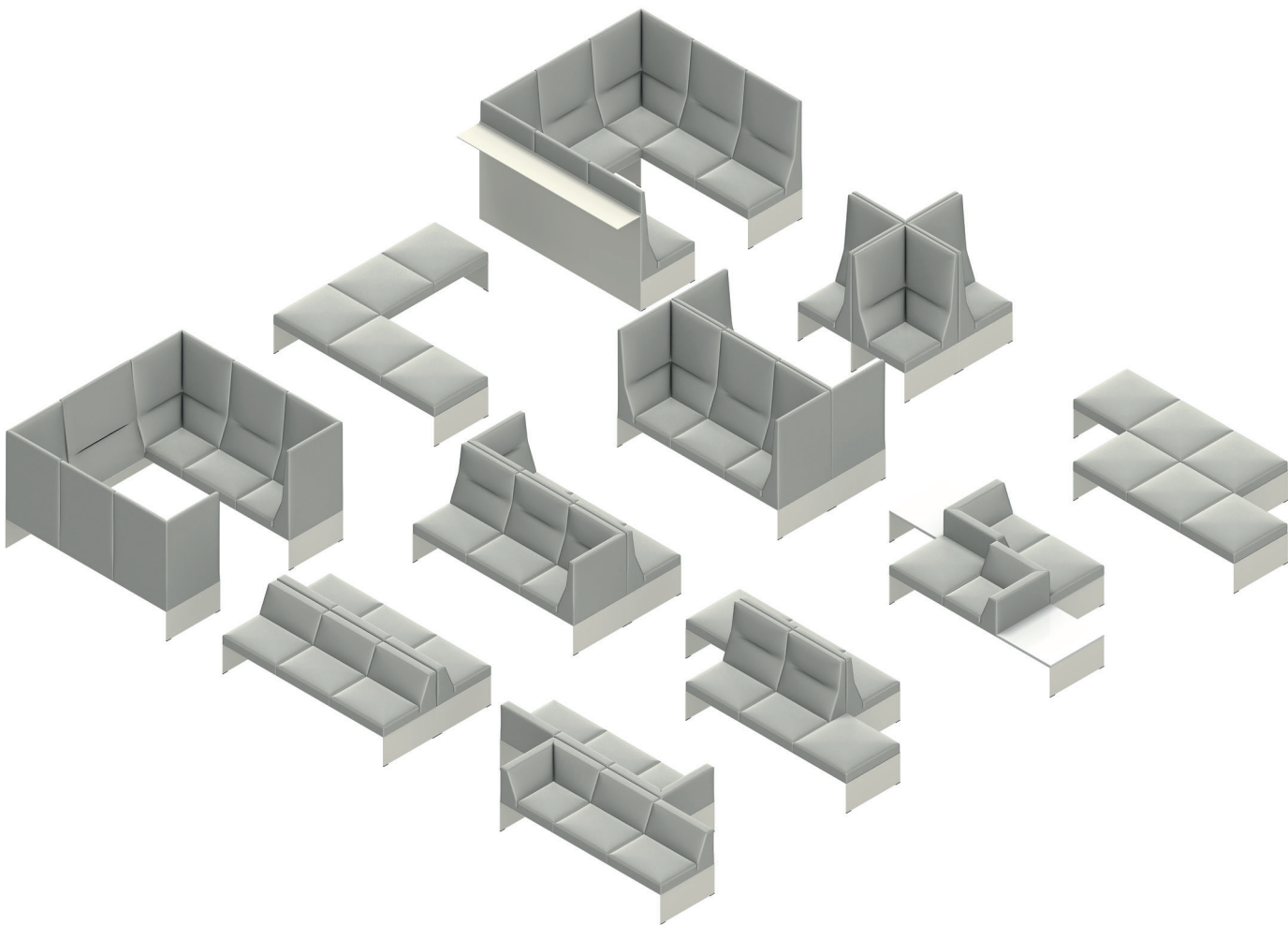

ASSEMBLY OF A LOUNGE ELEMENT

FITTING THE GLIDERS

Included in scope of delivery: 2x side section

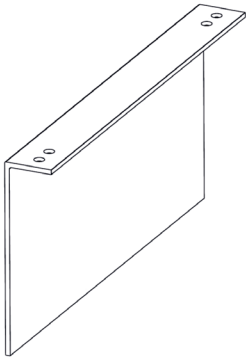

4x glider

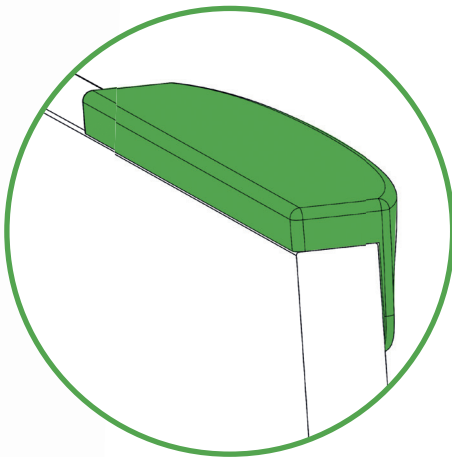
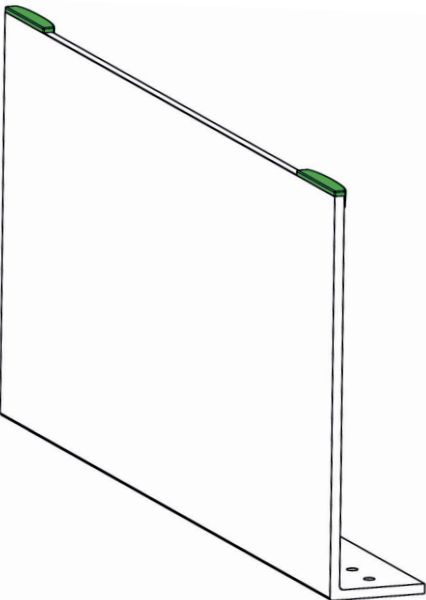
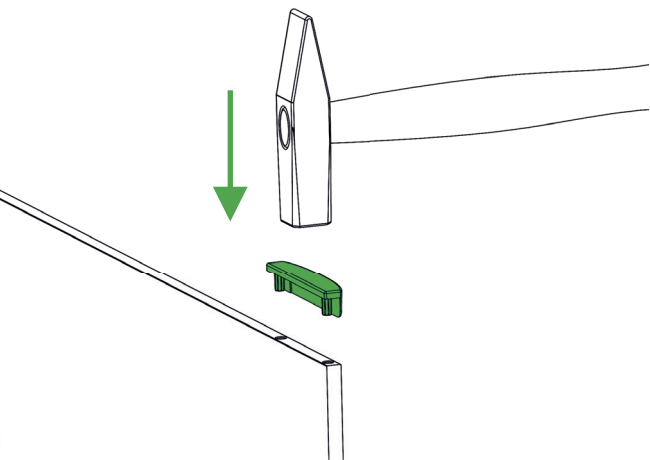
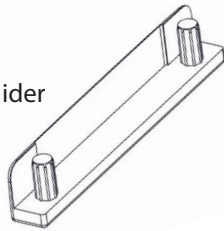

ASSEMBLY OF A LOUNGE ELEMENT

FITTING THE BASES

Included in scope of delivery:

2x cross beam

2x side section

8x M8x16

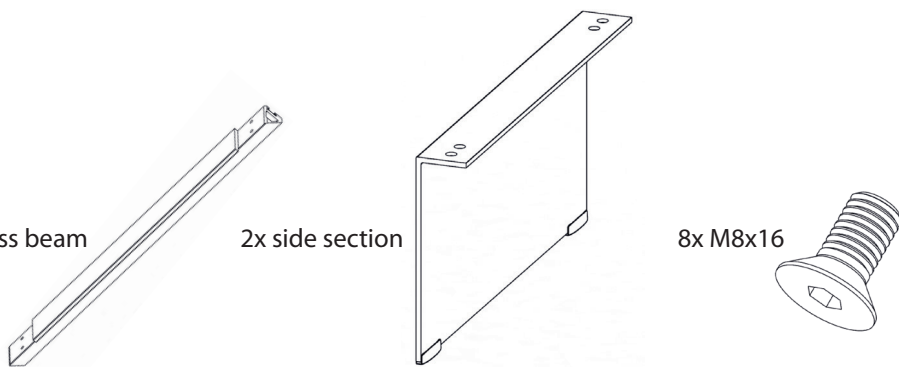

Frame sizes:

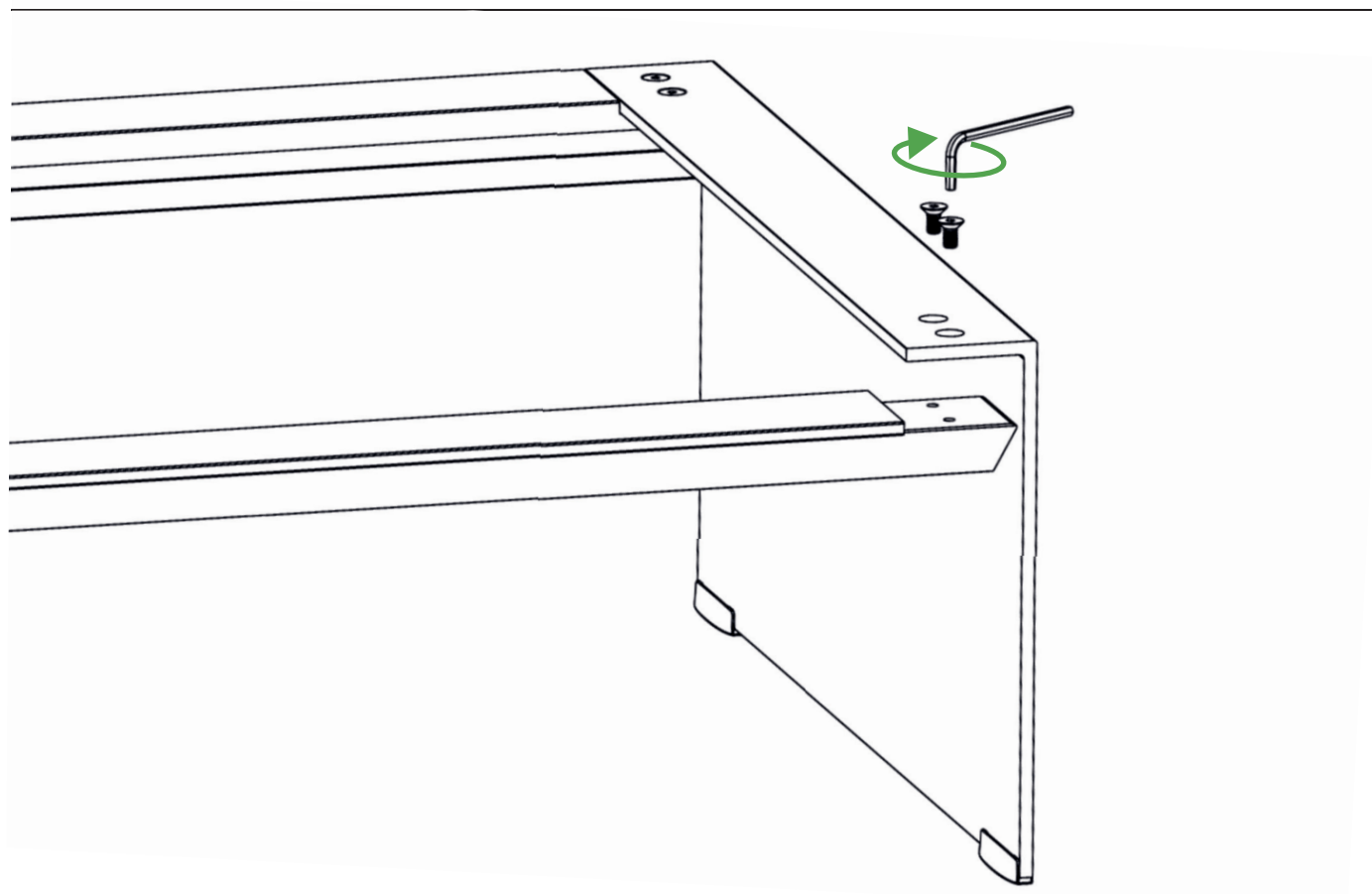
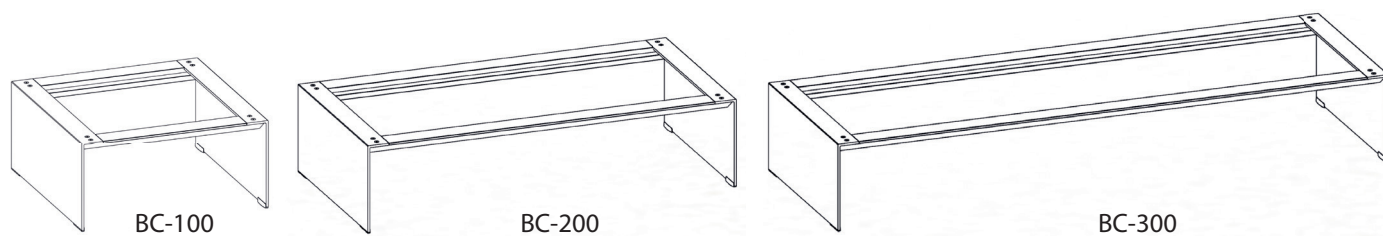

ASSEMBLY OF A LOUNGE ELEMENT

FITTING THE SEAT UPHOLSTERY

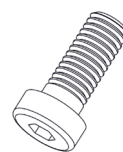
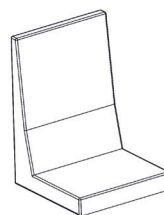
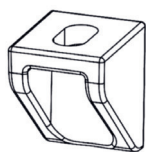

Included in scope of delivery:

4x/8x/12x retaining bracket

1x/2x/3x upholstery

4x/8x/12x M8x25

Position of frame sizes:

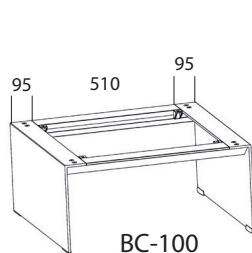

BC-100

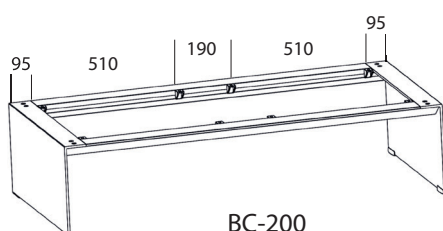

BC-200

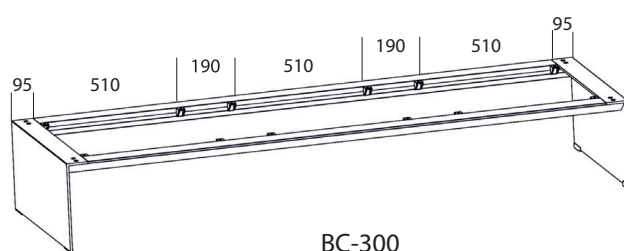

BC-300

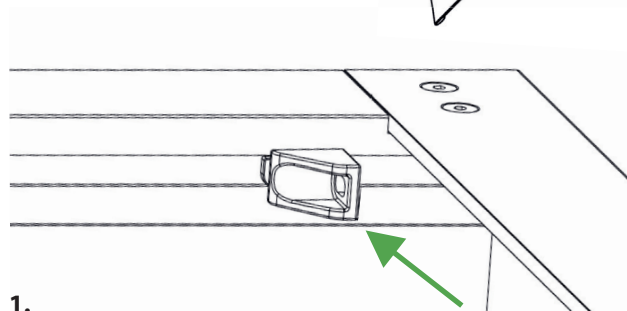
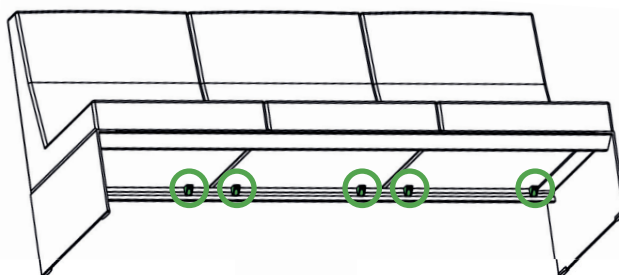

1.

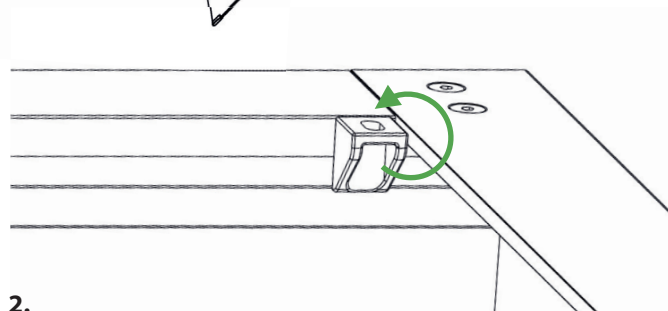

2.

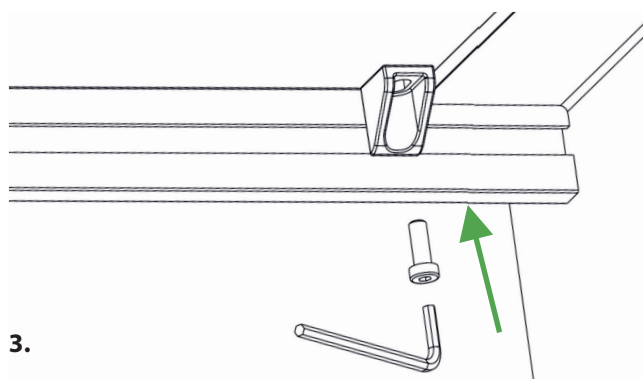

3.

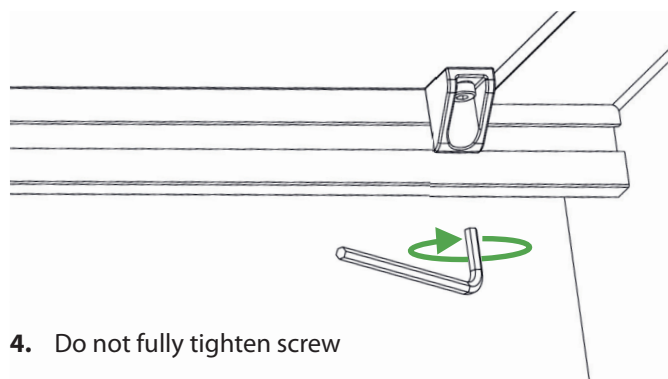

4. Do not fully tighten screw

ASSEMBLY OF A LOUNGE ELEMENT

CONNECTING THE SEAT UPHOLSTERY

Included in scope of delivery:

1x/2x connector fitting

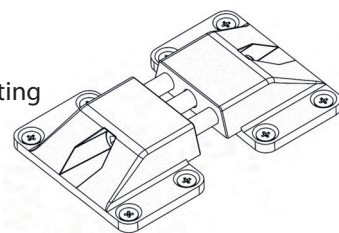

8x/16x Spax 4.5x25



Position per frame size:

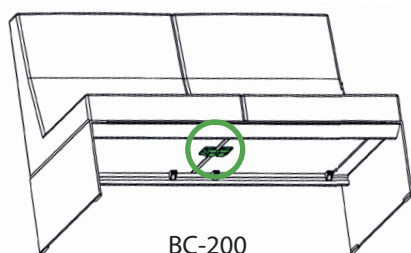

BC-200

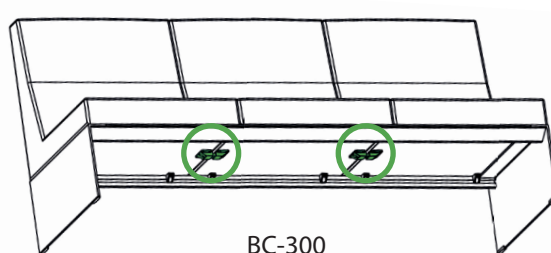

BC-300

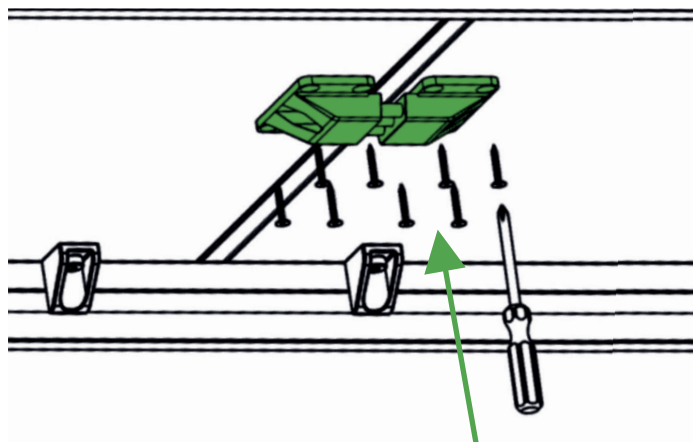

1. Screw on connector fitting with 10 mm spacing between the plastic parts

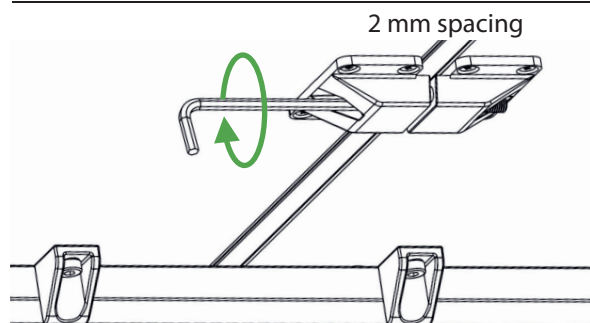
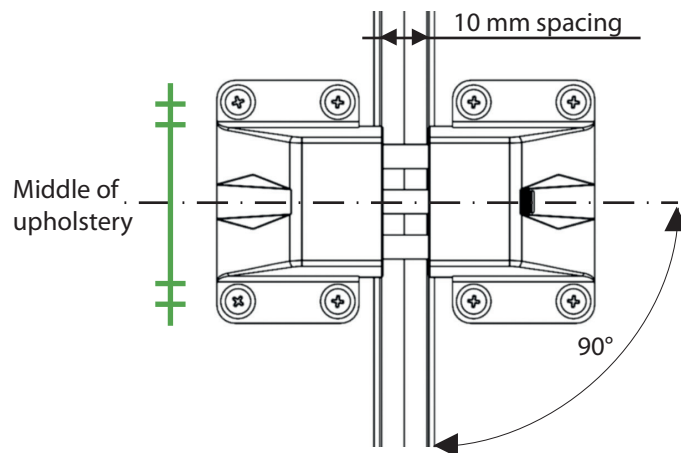

2. Pull upholstery together

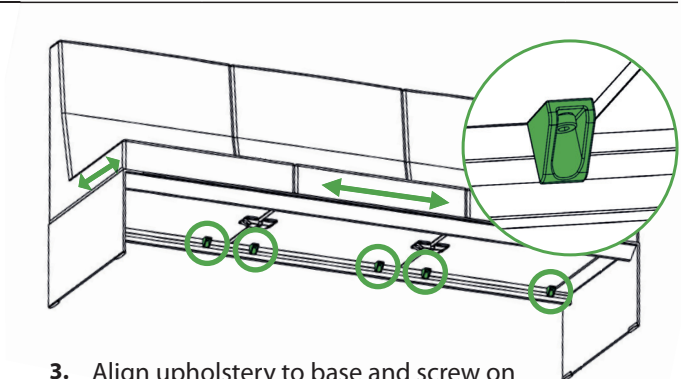

3. Align upholstery to base and screw on

ASSEMBLY OF A LOUNGE ELEMENT

FITTING A SUPPORTING PLATE

Included in scope of delivery:



4x shim/plate



4x M6x16/plate

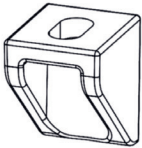

4x retaining bracket/plate

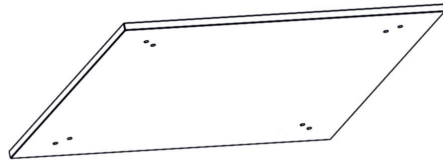

1x supporting plate

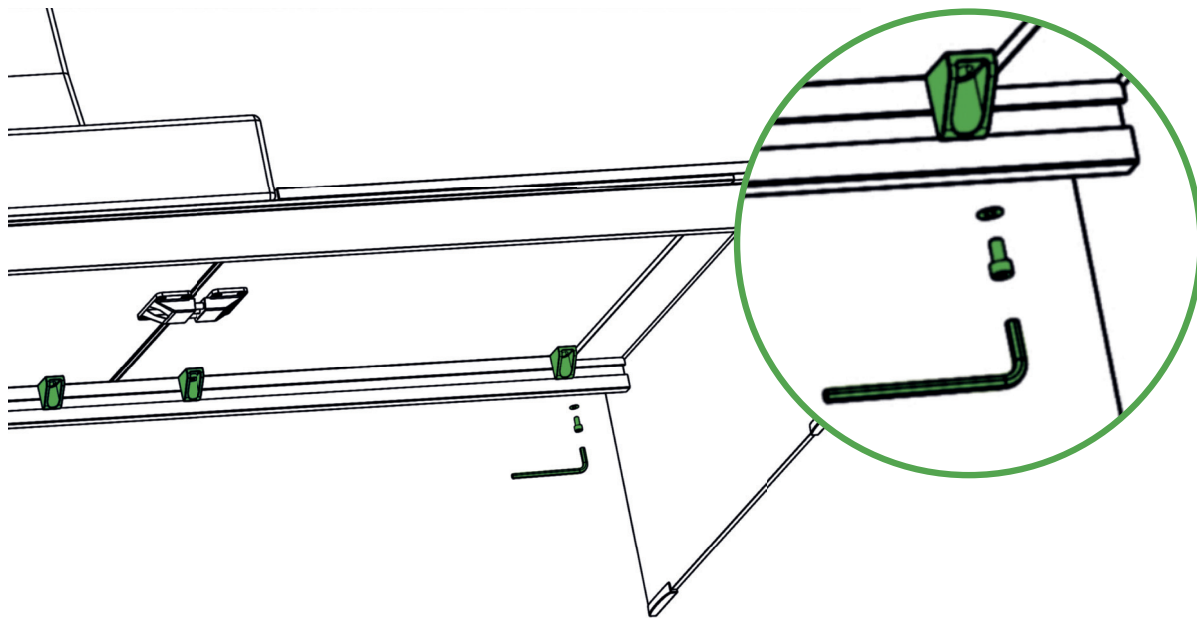

1. Screw supporting plate on to base

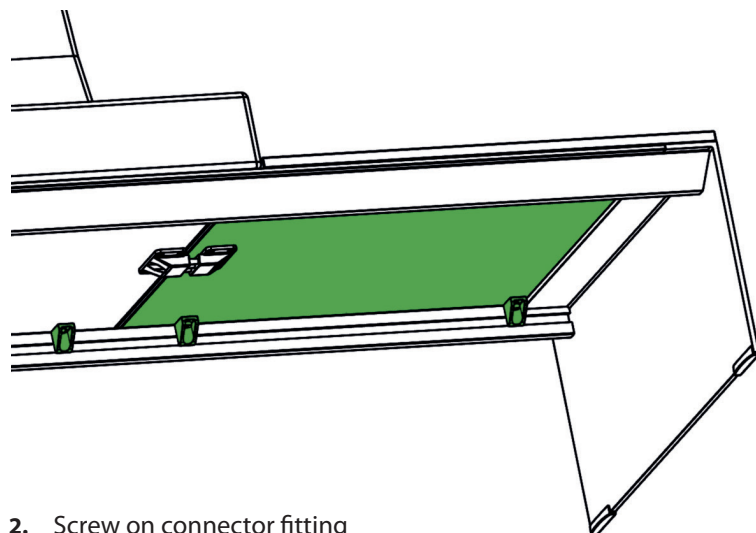

2. Screw on connector fitting

ASSEMBLY OF A LOUNGE ELEMENT

FITTING THE CABIN/FITTING THE BASES

Included in scope of delivery:

4x cross beam

2x side section 700

1x side section 2300

16x M8x16

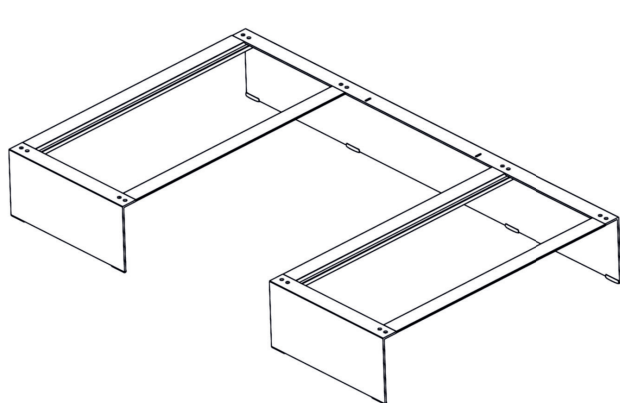
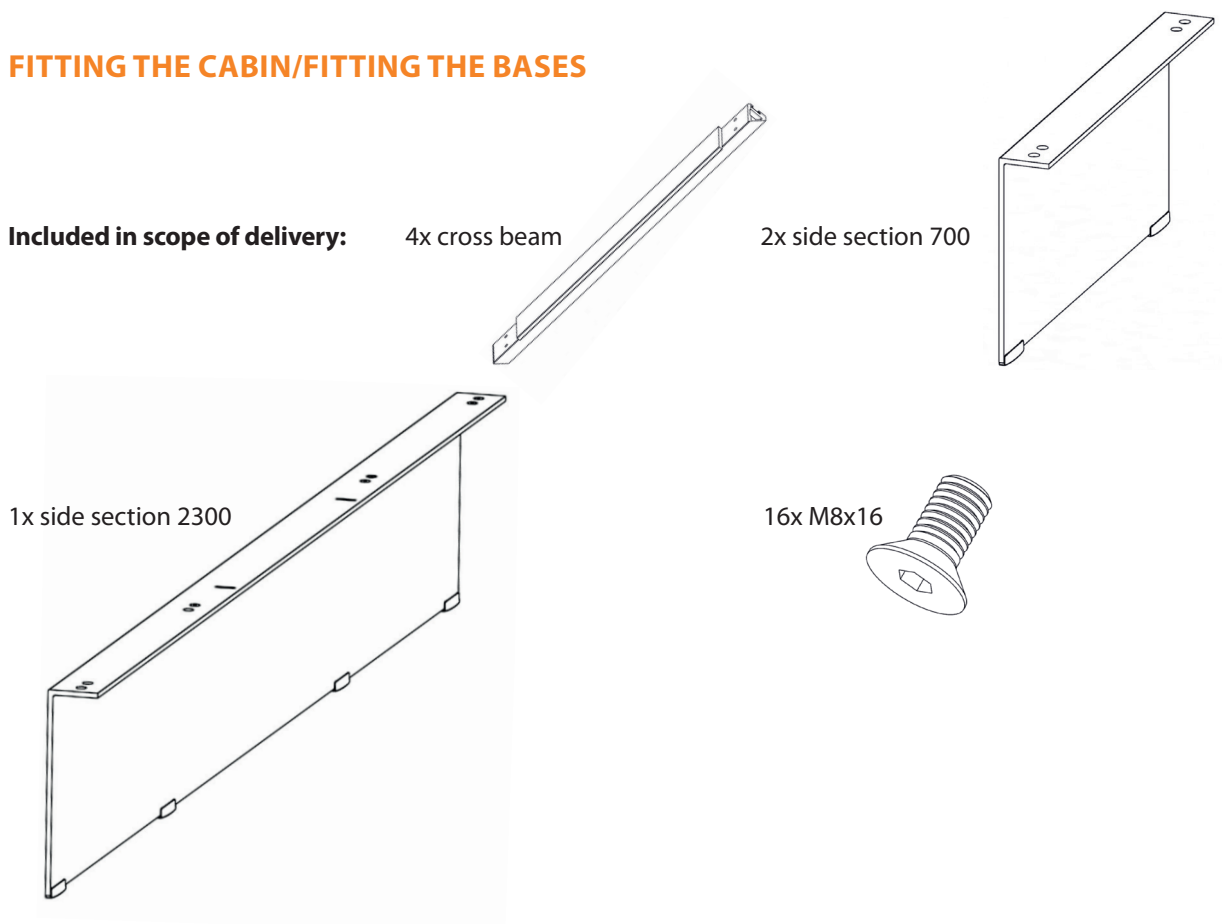

BC 2100

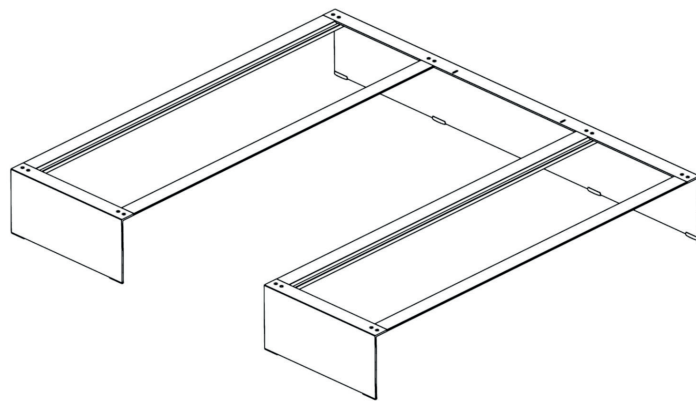

BC 3100/3200

The gliders and base are assembled in the same way as for the individual lounge element, see page 6-7

ASSEMBLY OF A LOUNGE ELEMENT

FITTING THE CABIN SEAT UPHOLSTERY

Included in scope of delivery:

16x/24x retaining bracket

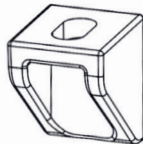

16x/24x M8x25



4x M6x25



2x/4x corner upholstery

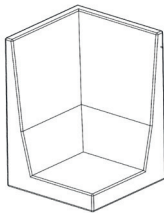

2x/4x upholstery

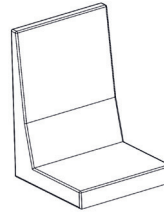

1x partition

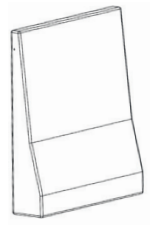

4x shim



1x strip

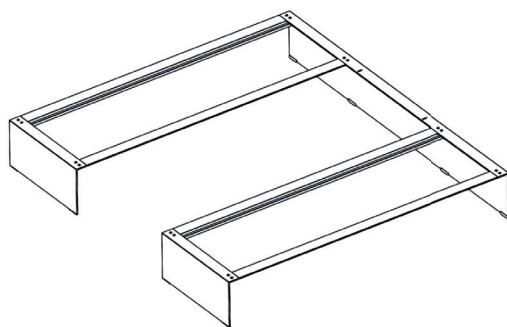
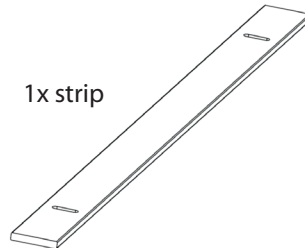

1. Fit base

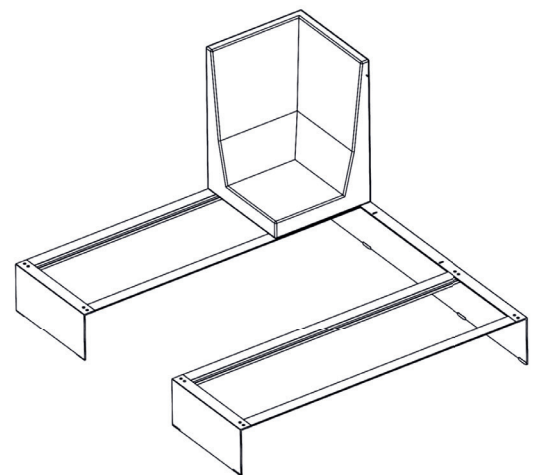

2. Screw on corner upholstery
(do not tighten screws)

ASSEMBLY OF A LOUNGE ELEMENT

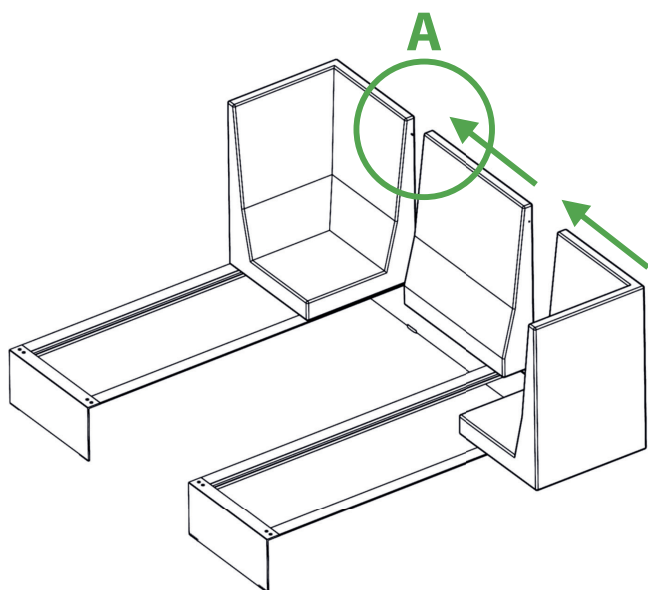

3. Slide together and screw on second corner upholstery

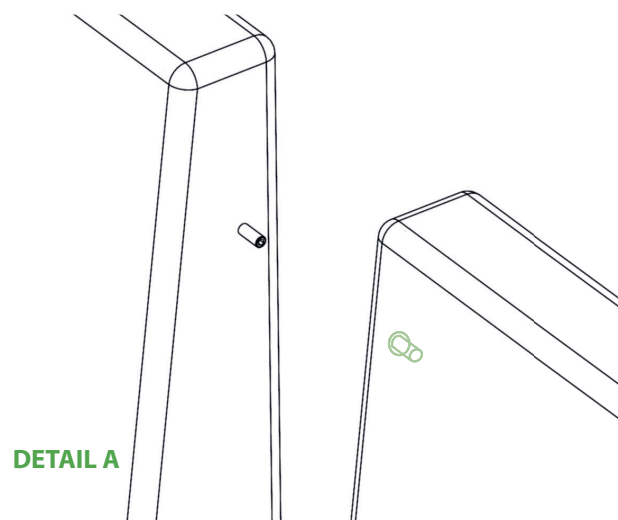

DETAIL A

Guide pin into hole

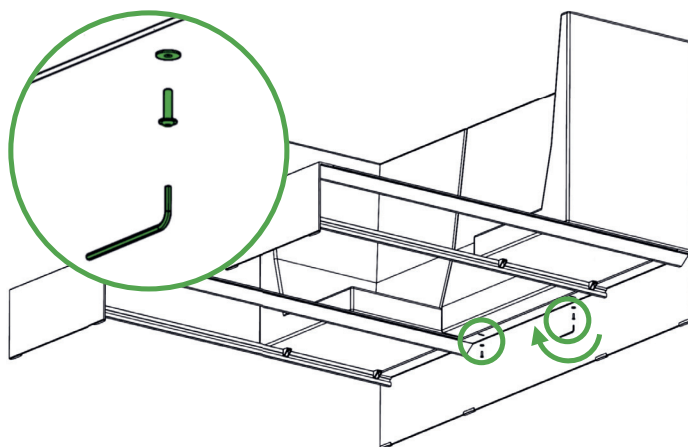

4. Screw on partition (do not tighten screws)

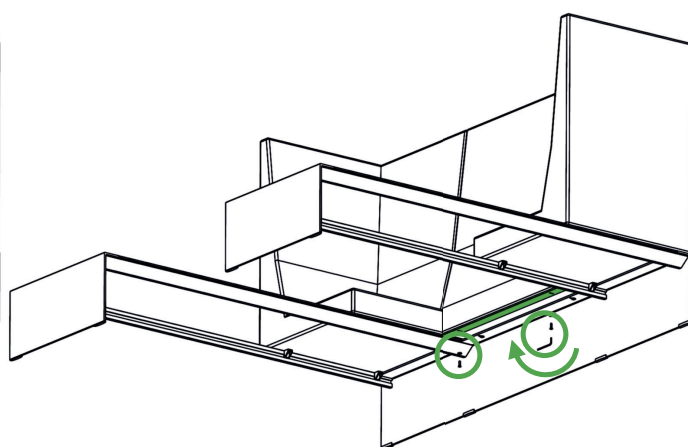

5. Screw on strip

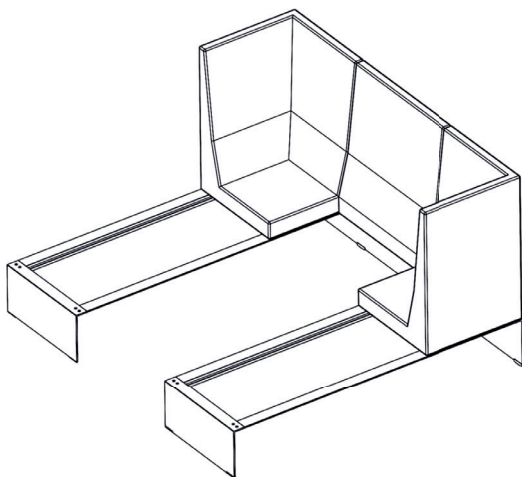

6. Align upholstery to base and screw on

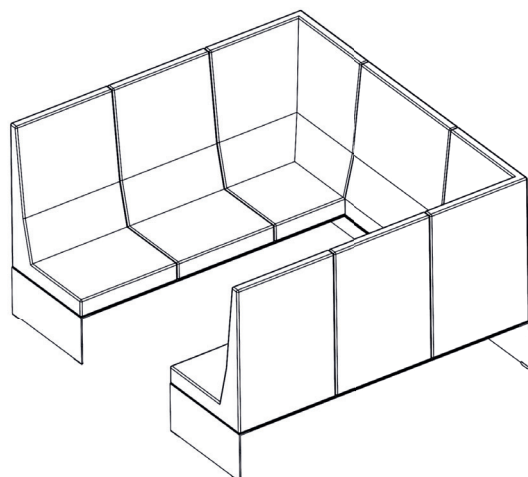

7. Screw on remaining upholstery (do not tighten screws)

ASSEMBLY OF A LOUNGE ELEMENT

CONNECTING THE CABIN SEAT UPHOLSTERY

Included in scope of delivery:

2x/4x connector fitting

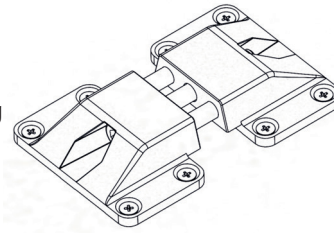

16x/32x Spax 4.5x25

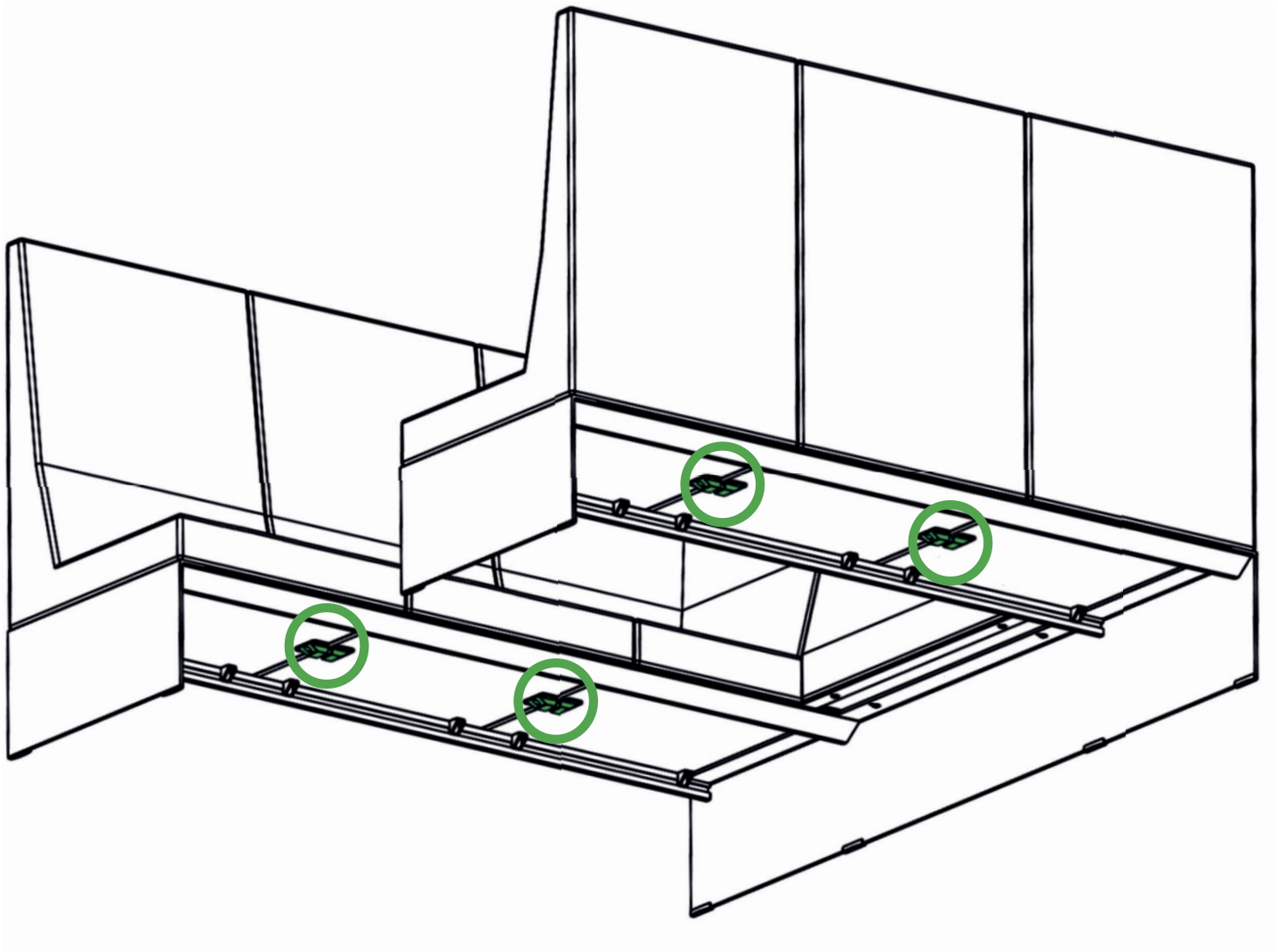

Align and connect upholstery and tighten screws, see page 8-10

CONNECTING SEVERAL LOUNGE ELEMENTS

LINEAR CONNECTION OF TWO LOUNGE ELEMENTS



1x shim



1x M8x25

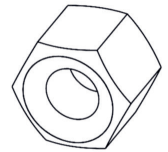

1x M8 nut

Included in scope of delivery:

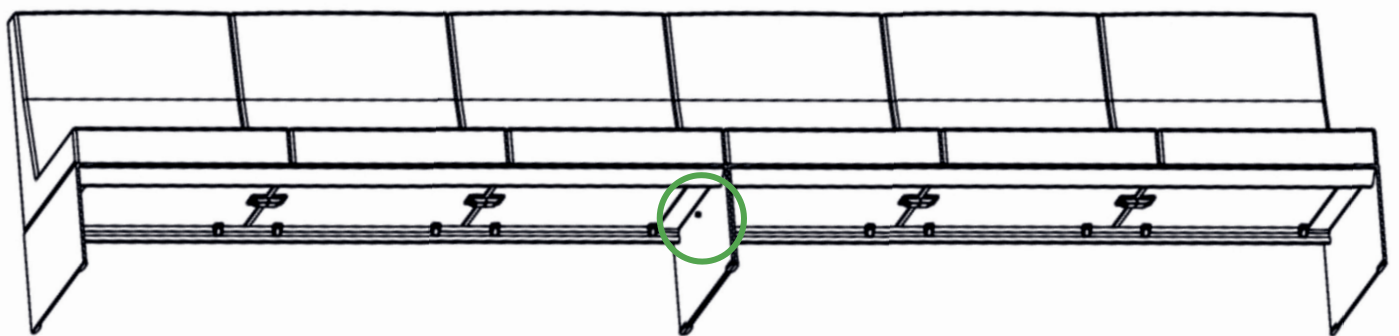

Side sections are supplied pre-drilled and have to be placed on the correct side during assembly

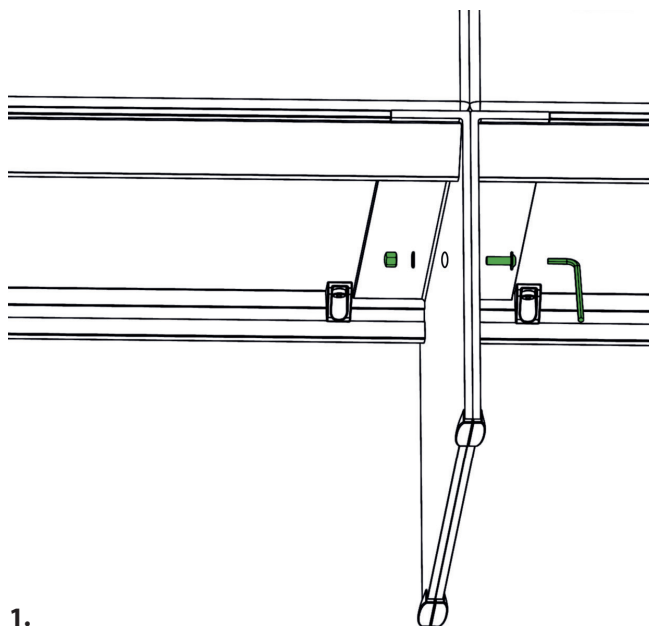

1.

Position lounge elements in linear fashion and screw together

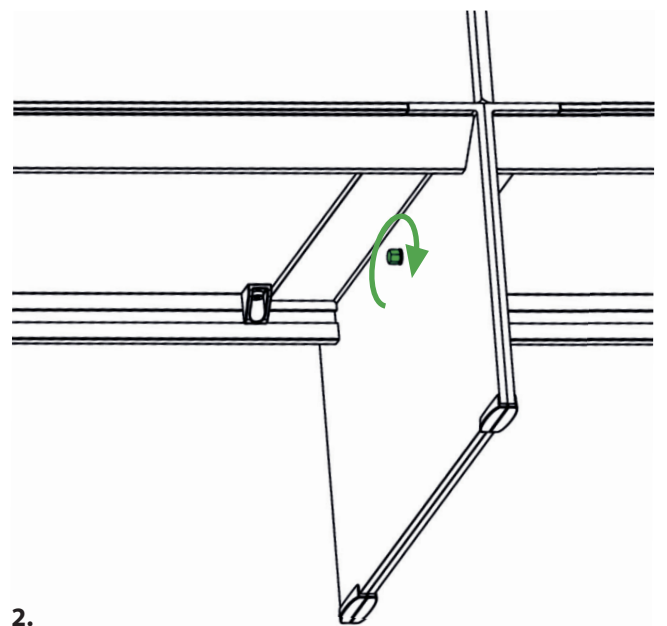

2.

CONNECTING SEVERAL LOUNGE ELEMENTS

CONNECTION OF TWO LOUNGE ELEMENTS BACK TO BACK

Included in scope of delivery:

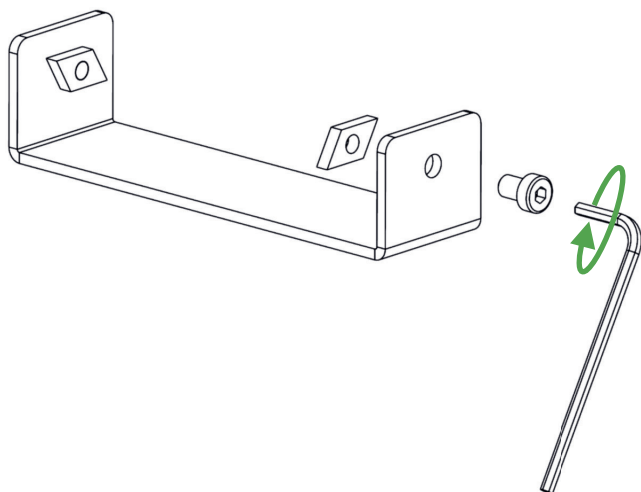
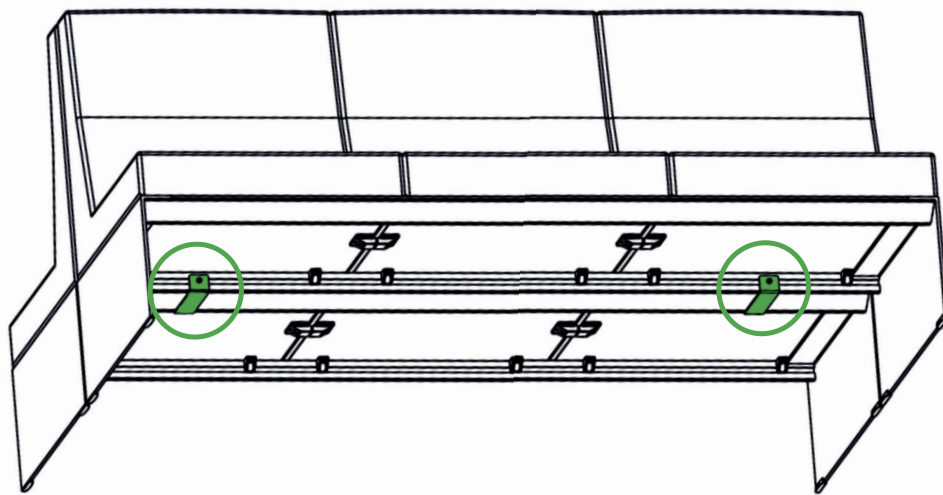
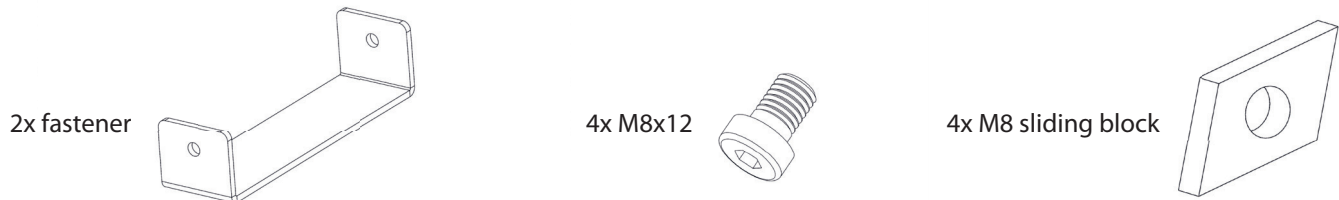

1. Fit sliding block

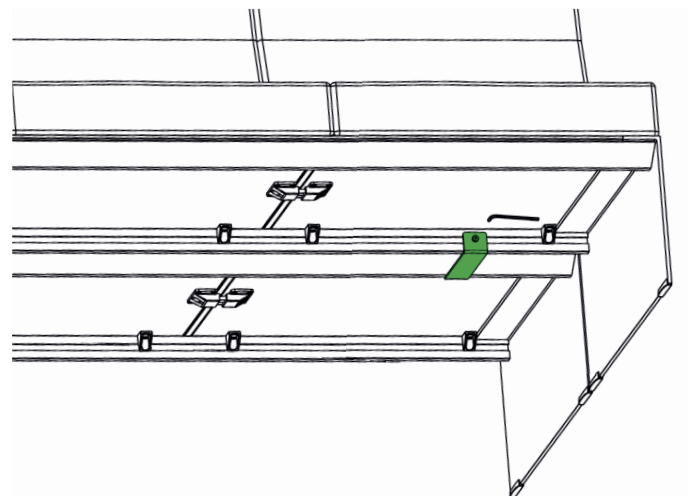

2. Position lounge elements back to back and screw both fasteners on to cross beam near side section

CONNECTING SEVERAL LOUNGE ELEMENTS

CONNECTION OF TWO LOUNGE ELEMENTS ACROSS A CORNER

Included in scope of delivery:

1x corner connector

2x M8x25

2x sliding block

2x M8x12

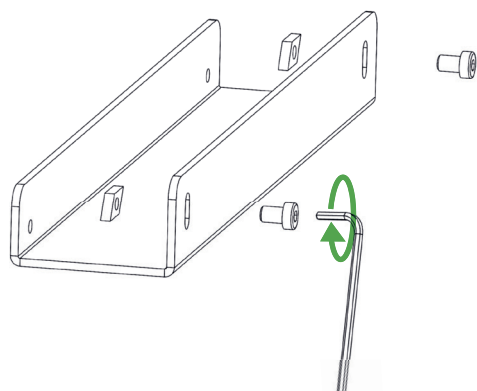
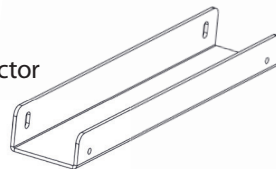
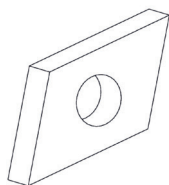

1. Fit sliding block

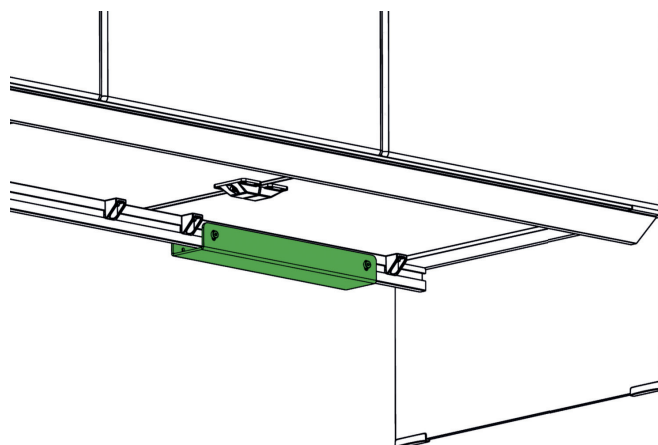

2. Screw corner connector to cross beam

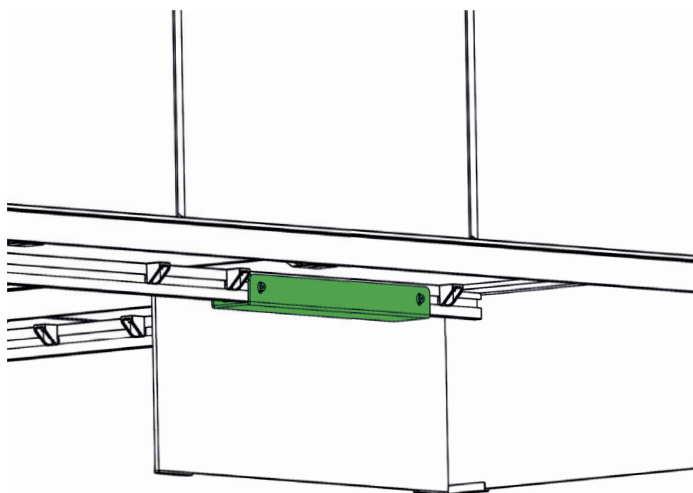

3. Position lounge elements across corner and screw corner connector on to side section

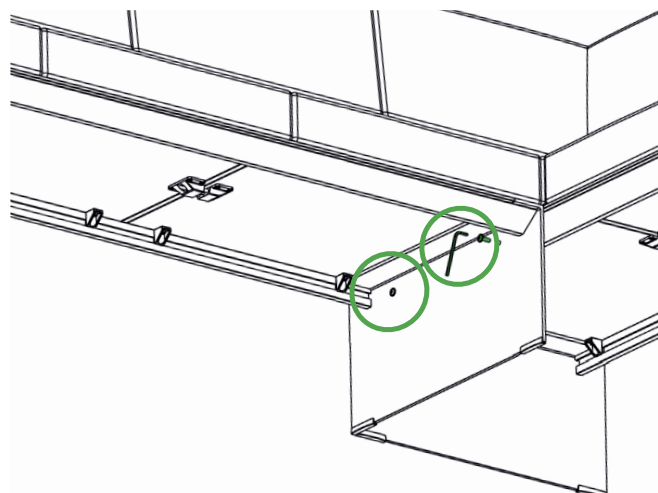

4. Side section is supplied pre-drilled and has to be placed on the correct side during assembly

ADDING THE BAR COUNTER

FITTING THE BAR COUNTER

Included in scope of delivery:

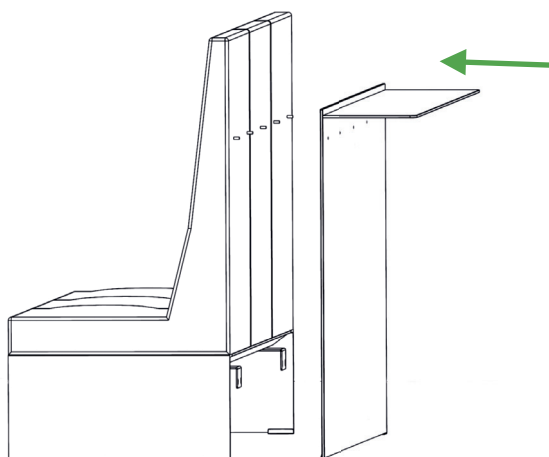

1. Slide bar element on to threaded pins

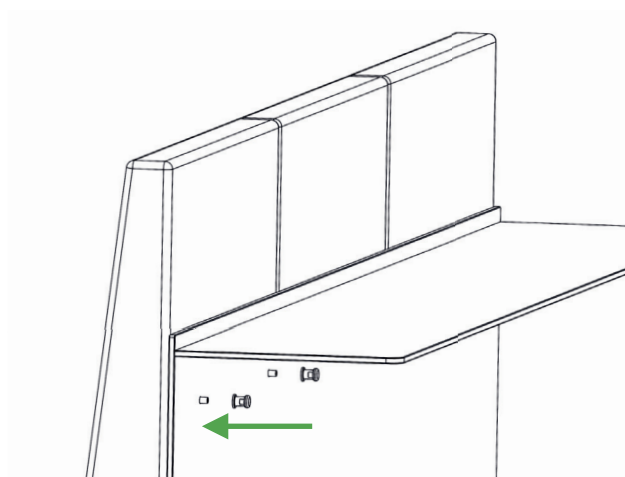

2. Screw on clothes hook

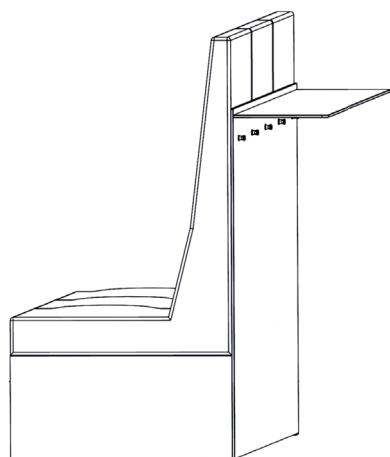

3.

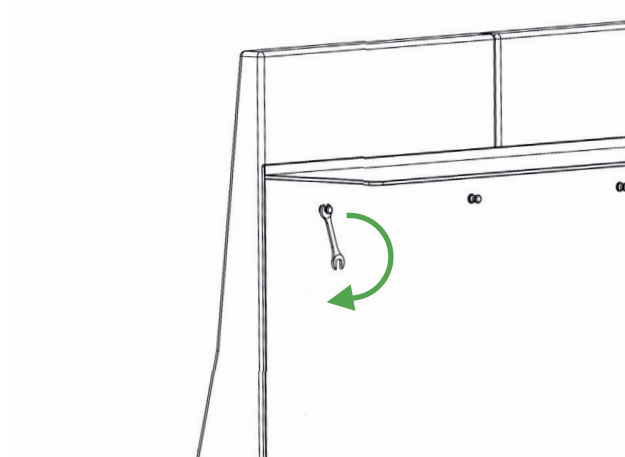

4. Screw clothes hook tight

ADDING THE BAR COUNTER

FITTING THE BAR COUNTER

Included in scope of delivery:

4x shim



4x M5x10

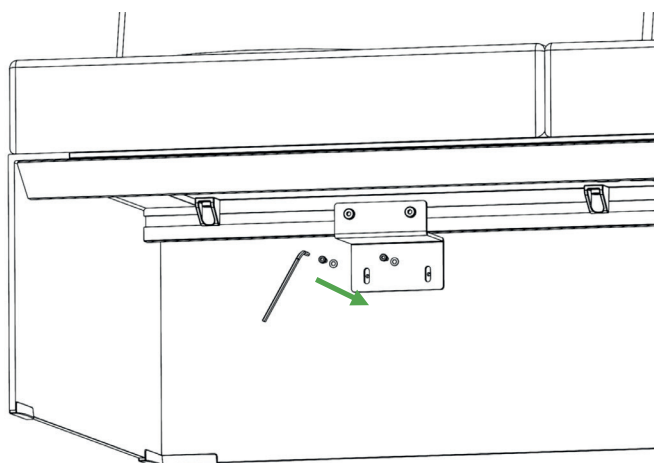
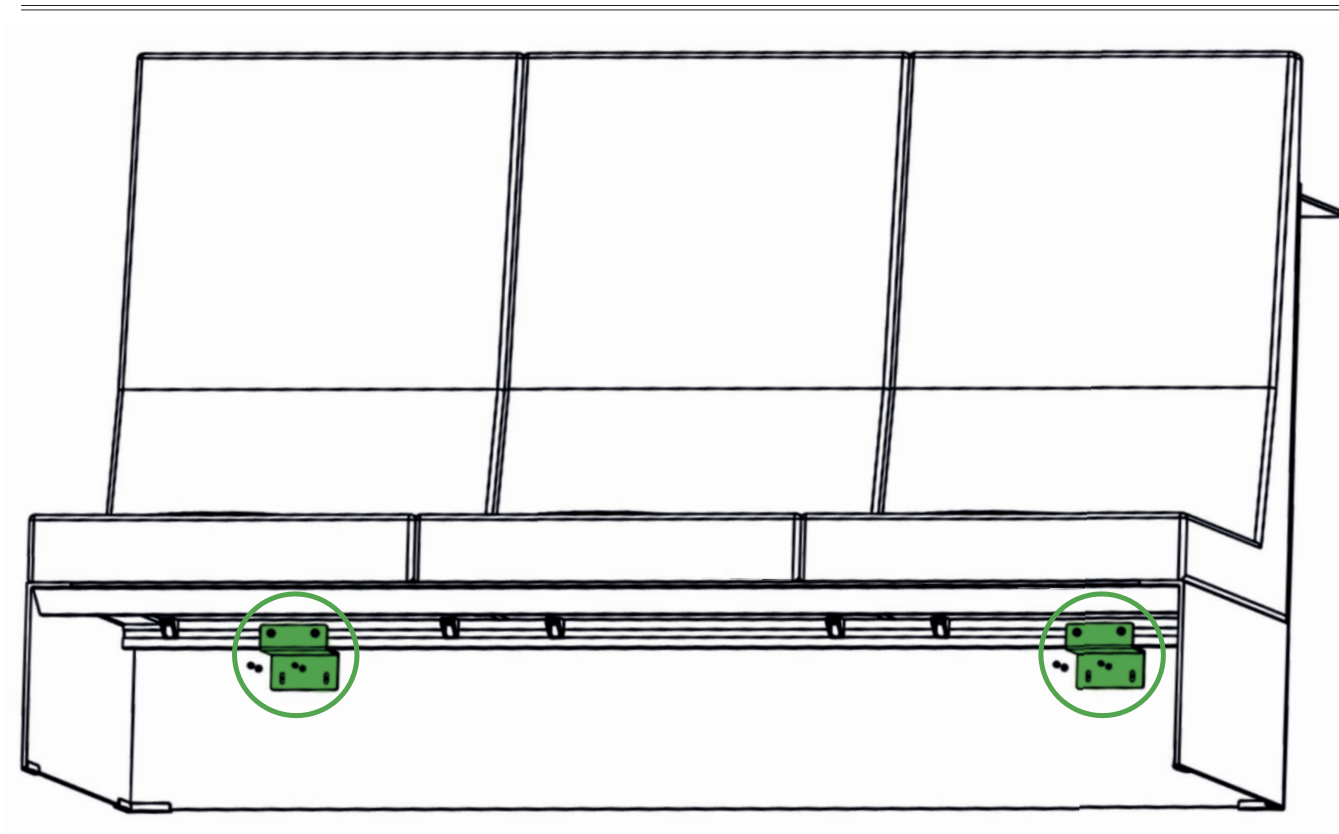

1. Screw bar element on to base

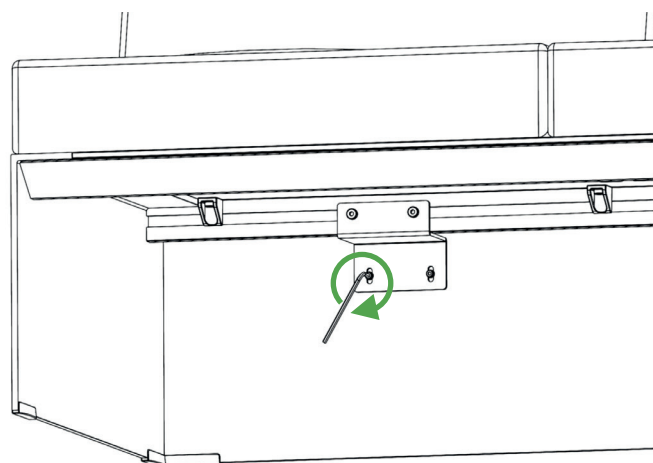

2.

ELECTRICS AND CABLING

FITTING THE PROFILE BOX UNDER THE SEAT UPHOLSTERY

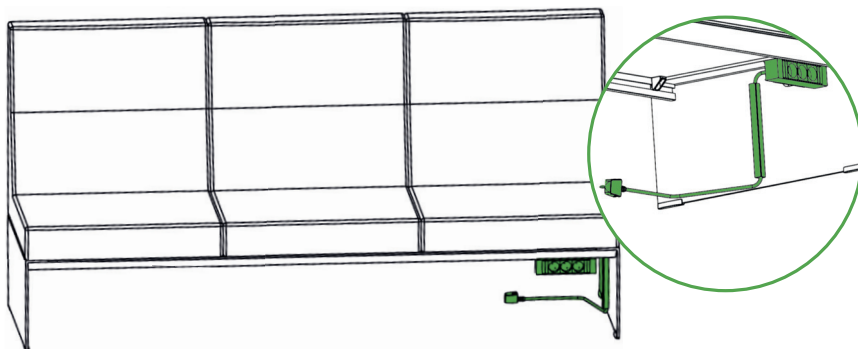
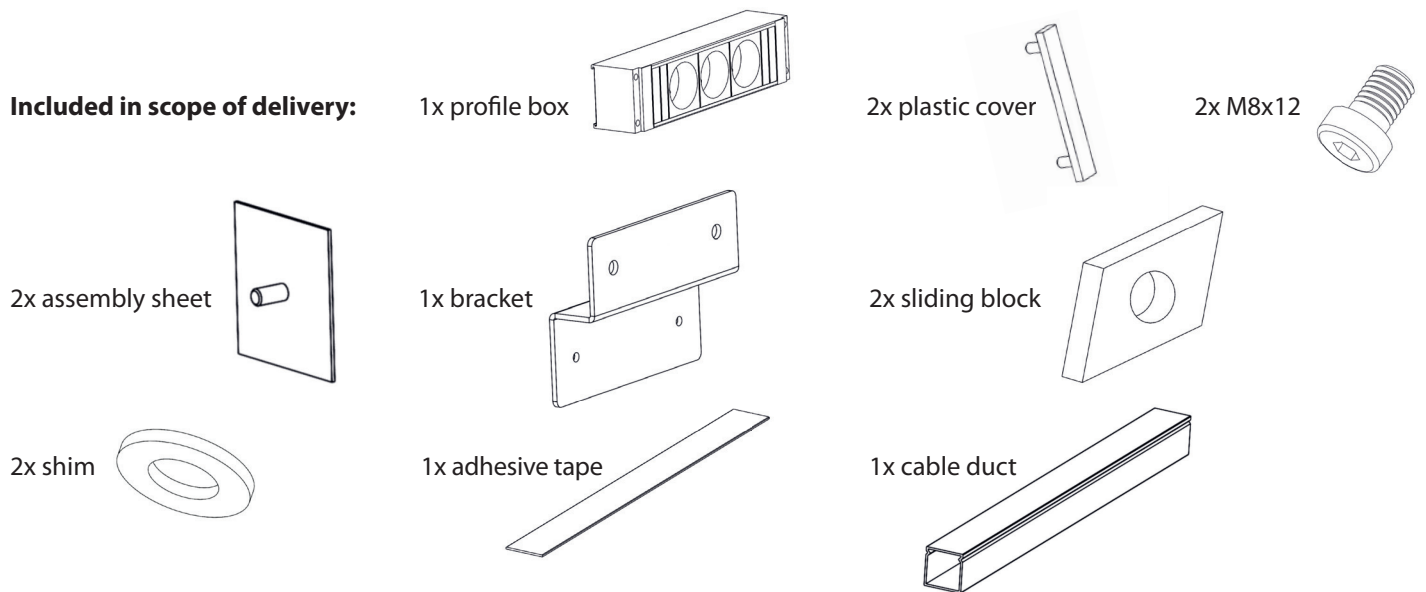

Screw the profile box on to the appropriate bracket. Position bracket on cross beam and screw tight. Stick on cable duct with adhesive tape

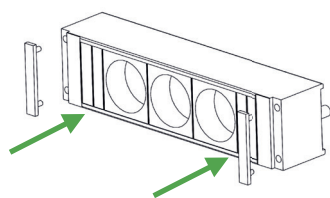

1. Fit plastic cover

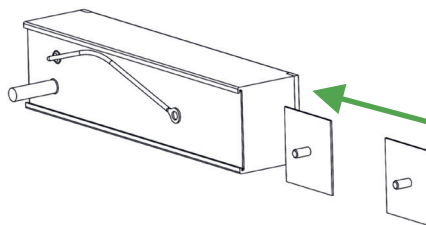

2. Slide in assembly sheets at side

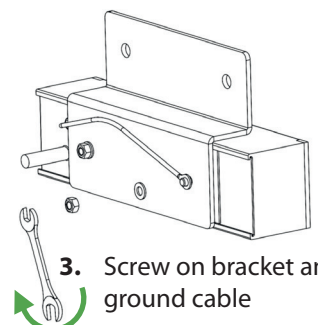

3. Screw on bracket and ground cable

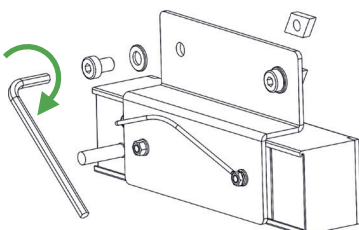

4. Fit sliding block

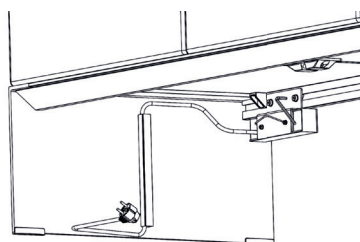

5. Fit electrics to cross beam and bring cable duct into desired position

ADDITIONAL INFORMATION

GENERAL INFORMATION ABOUT ASSEMBLY

The assembly instructions provide general guidelines for assembling your banc lounge system

- The steps described should be observed for all modular lounge elements
- The assembly tools suggested are simply recommendations from Brunner GmbH
- Only the materials supplied may be used for assembly
- Brunner GmbH accepts no liability for damage caused during assembly

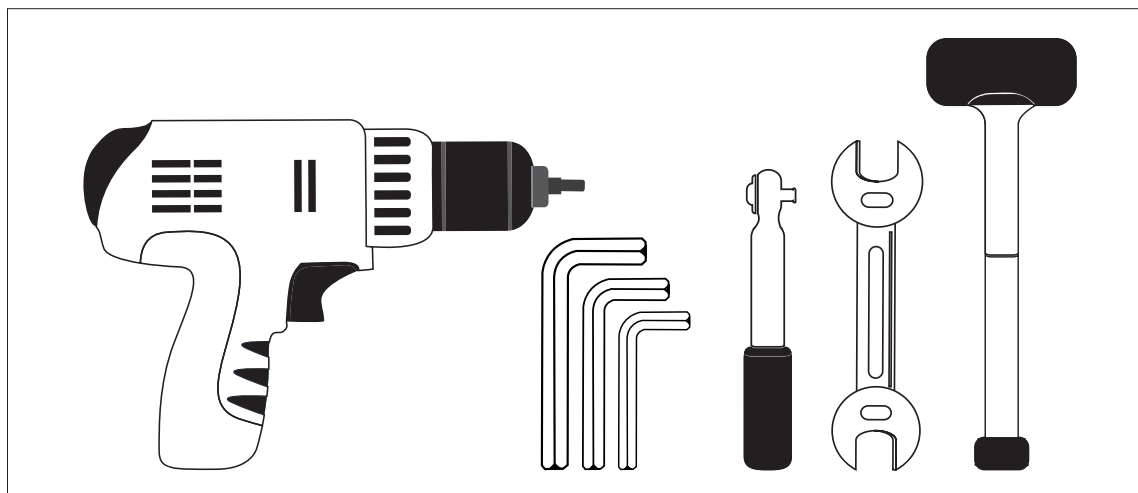

ASSEMBLY TOOL FOR THE MODULAR BANC LOUNGE SYSTEM

- Cordless screwdriver with hexagon insert, size 3; size 5; size 6
- Hexagon wrench, size 3; size 5; size 6
- Ratchet
- Forked wrench size 8; 10
- Plastic hammer

CARE INSTRUCTIONS – POWDER-COATED BASES

During normal use, it is sufficient to wipe the powder-coated surfaces with a clean, soft, slightly damp cloth. Any particularly dirty areas can be cleaned with a standard, grease-dissolving all-purpose cleaner. However, abrasive cleaning agents and WC or sanitary cleaners must not be used because they may damage the powder-coated surface. Acid or alkaline cleaning agents and organic solvents must also not be used. Please only use soft cotton cloths for cleaning purposes and certainly do not use plastic sponges, wire wool or steam jet devices, which could permanently damage the surface. The gliders' surfaces should be regularly cleaned of coarse pieces of dirt or deposits.

CARE INSTRUCTIONS – COVER MATERIALS AND LEATHER

Cover materials should be regularly vacuumed with a soft attachment. We recommend following the cleaning and care instructions of the material manufacturer to remove stains and dirt deposits. During normal use, it is sufficient to wipe the leather covers with a dry or slightly damp cloth. If dirt has dried on, the best way to clean the area is with a weak neutral soap solution and a soft cloth. Then remove the soap suds with a damp cloth. The leather cover must never be treated with standard cleaning agents (washing-up liquid, all-purpose cleaner etc.) because they will irreversibly damage the leather surface (impregnation/glaze). Solvents, cleaning petrol, stain removers, spirit, shoe cream etc. must also not be used. We offer an appropriate care kit for cleaning your leather covers.

Note

For details, prices, terms and conditions, refer to the current price list. We reserve the right to technical changes, errors and colour variations. Some models are displayed as special versions that are subject to additional costs.

Imprint

Product design:

jehs+laub

Illustrations:

Patrice Mutschler, Brunner GmbH

Hanne Haaf, Brunner GmbH

Text:

Hanne Haaf, Brunner GmbH

Design:

Kerstin Lamprecht, Brunner GmbH

www.brunner-group.com

© Brunner GmbH 2015 . Im Salmenkopf 10 . D-77866 Rheinau, Germany
Phone +49 78 44. 40 20 . Fax +49 78 44. 40 28 0 . info@brunner-group.com